

MEC-SAT-M102

Mini PCI-e 2-port Serial ATA III RAID Board



- Single-Lane (x1) PCI-Express with throughput up to 5.0/2.5Gbps
- Fully compliant with PCI-Express Base Specification Rev. 2.0
- Two Serial ATA III 6Gb/s ports (Compatible with Serial ATA I and II)
- Transfer rate of 1.5Gbps, 3.0Gbps and 6.0Gbps
- IDE/AHCI mode supported
- SPAN, RAID 0 & RAID 1 supported
- SATA Port Multiplier and Hot-Swap supported



Overview

MEC-SAT-M102 is a serial ATA III RAID card for embedded PC. The card follows the Mini PCI-e standard which is compliant with PCI Express x 1 classification and small form factor (30.00 x 50.95 mm). This board fits in any host computer that has Mini PCI-e card slots. MEC-SAT-M102 has great compatibilities with all types of Serial ATA devices, including hard drive, solid state drive, and optical drive.

Top Performance

MEC-SAT-M102 comes with 2 ports of newest Serial ATA III interfaces that support the application of the industry's newest and fastest 6Gb/s hard drives while providing backward compatibility to SATA 1.5Gb/s and 3Gb/s hard drives. MEC-SAT-M102 follows the standard of PCI-Express 2.0 and SATA revision 3.0, and supports IDE/AHCI mode and Hot-Swap function.

High Usability

MEC-SAT-M102 is tested to be compatible with various Windows Operation Systems. The SATA connection cable is included in the standard package.

Specifications

General

PCI-Express Revision:

PCI-Express Base Specification Rev 2.0

PCI-Express Electromechanical Revision:

PCI-Express Mini Card Electromechanical Rev. 2.0

Hardware

Controllers: Asmedia ASAM1061R

Bus: Single-Lane (x1) PCI-Express with throughput up to 5.0/2.5Gbps

RAID: SPAN, RAID 0, RAID 1

Interface (Connector)

Serial ATA III: 2 (SATA)

Performance

Data Transfer Rate: SATA III transfer rate of 1.5Gbps, 3.0Gbps and 6.0Gbps

Driver Support

Operating Systems: Win 7, Win 8, Win 10

Power Requirement

Power Consumption: 301mA@3.3V

Dimensions

Width x Length (mm): 30.00 x 50.95

Environmental Limits

Operating Temperature: 0°C ~ 70°C

Storage Temperature: -40°C ~ 95°C

Humidity (non-condensing): 5% ~ 95%

Regulatory Approvals

EMC: CE, FCC

EMI: EN 55032, EN61000-3-2, EN61000-3-3,

FCC Part 15 Subpart B

Class B

EMS: En 55024, IEC 61000-4-2, IEC 61000-4-3,

IEC 61000-4-4, IEC 61000-4-5, IEC 61000-4-6,

IEC 61000-4-8, IEC 61000-4-11

Reliability

Warranty: 3 years

Dimensions

Unit: mm

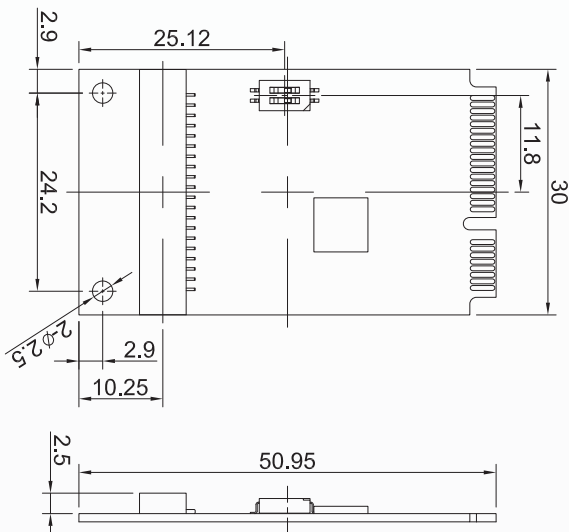

Package Checklist

- Mini PCI-e Card x 1
- 20Pin Cable with two SATA Connectors (30cm) x 1
- Quick Installation Guide (Printed) x 1
- CD x 1

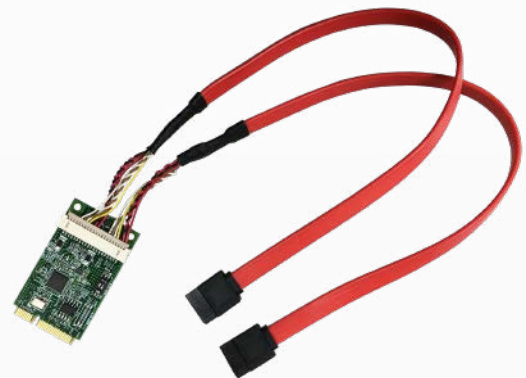

Ordering Information

Available Models

MEC-SAT-M102

Mini PCI-e 2-port Serial ATA III RAID board